

APRIL 11, 2011

HAMILTON GRAND

OFFICE

CONDO FEES

(REFER TO MASTER CHART FOR INDIVIDUAL UNITS)

Include;

- Building directory
- Separate elevator
- Heating/Cooling/Water
- Building insurance
- Window washing
- Building maintenance
- Building administration
- Heat pump servicing
- Reserve fund

INCLUDED

- Carpet flooring
- Drywall finished and painted
- Ceiling lighting
- Some partitions and doors
- Phone & cable outlets

UPGRADES

- Kitchenette
- Washrooms
- Wood or stone floors
- Wood panelling
- Murphy bed, built-in library
- Workstations, counters
- Window coverings

DEPOSIT:

- i) \$1,000 (ON SIGNING)
- ii) \$4,000 IN 60 DAYS
- iii) \$5,000 IN 180 DAYS
- iv) BALANCE TO 15% IN 360 DAYS

PARKING: \$18,000

(deposit \$2,000)

H.S.T.

is not included in purchase price of units or parking.

THE ONLY OFFICE

BUILDING THAT PROVIDES...

- Individual office ownership
- Concierge
- 24-hour reception
- 24-hour security
- 24-hour room service
- 24-hr café
- On-site spa/gym membership
- Lobby bar,
- Housekeeping + handyman
- Private boardrooms
- Distinctive architecture
- the only "Class A" building in Hamilton

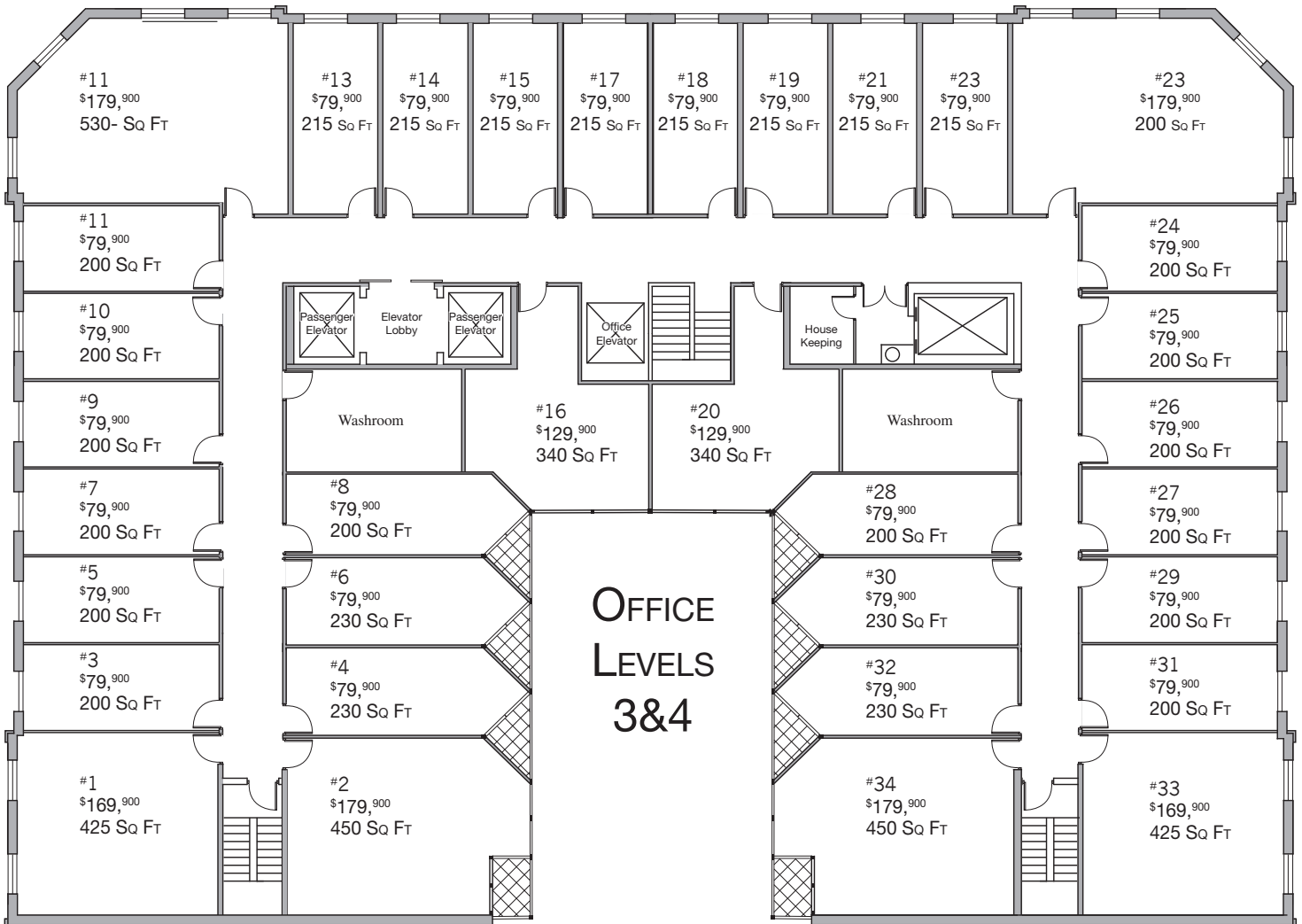

Builder reserves the right to adjust prices.

